

Installation and operating instructions of portable LED spotlight

General information

Please read and follow these instructions carefully to ensure safe and reliable operation. Keep this instruction in a safe place for future reference to be able to answer your questions.

Attention: In case of damage or consequential damage caused by non-observance of these instructions, the warranty claim becomes void.

Performance features of the portable spotlight

white LED as illuminant, emergency light function, 3 brightness levels and flashing function

Areas of application

Robust, reliable work lamp for all situations.

Whether in leisure time, camping and hunting or as a companion at work, this super-bright signal light always provides the optimum light.

The maintenance-free lead battery allows a light duration depending on the performance level up to 18h. The charging can be done either with the included plug-in power supply or the 12V adapter. Due to the flashing function, this light can be used as a warning light.

Components

- 1 Lamp head
- 2 Carrying handle
- 3 hinge
- 4 Operating mode switch
- 5 Charging socket
- 6 Battery level indicator
- 7 Charging contacts for wall bracket
- 8 Wall bracket
- 8a Charging connector
- 8b Retaining pins
- 8c Charging socket from wall bracket

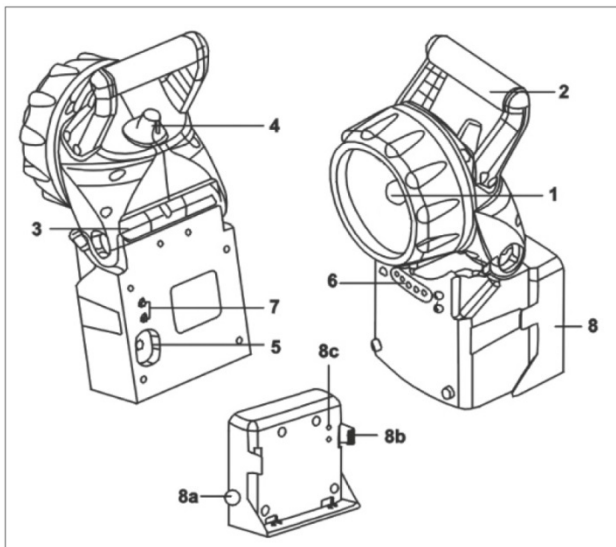

Emergency lighting function

In the event of a power failure, the work lamp switches on automatically. Proceed as follows:

1. Turn on the work lamp
2. Set desired function/brightness
3. Connect charger to wall bracket or directly to signal lamp
4. Connect charger to 230V socket - the lamp turns off

Simulation emergency light function

Disconnect the charger from the 230V socket - the signal lamp switches on automatically.

Electronic deep discharge protection

This work lamp is equipped with an electronic deep discharge protection in order to protect the rechargeable battery. This extends the lifetime of the battery and protects the environment.

Important safety notice

The operation under adverse environmental conditions must be avoided under all circumstances. Adverse environmental conditions are: Ambient temperatures above 50°C, flammable gases, solution medium, vapours and dust.

If it can be assumed that safe operation is no longer possible, the device must be taken out of operation immediately and secured against unintentional operation. Safe operation can no longer be assumed if the device no longer functions properly, shows visible damage, if it is damaged in transit, or if it is stored under unfavorable conditions.

Service and repair work may only be carried out by authorized specialist personnel.

Important note / tips for a long battery life!

Before initial use please charge for approx. 24 hours.

Lead-gel batteries achieve their longest life if they are stored in full condition. Reconnect the signal lamp to the charger after use. The signal lamp can remain permanently connected to the charger. The electronic charging circuit ensures optimum charging conditions. This prevents the battery from being overcharged. The lead-gel battery of the signal lamp can be charged approx. 300 - 400 times. Replace the battery only with the same type, voltage and capacity.

Note on environmental protection

This product must not be disposed of with normal household waste at the end of its life, but must be taken to a collection point for the recycling of electrical and electronic equipment. The symbol on the product, instruction manual or packaging indicates this.

The materials are recyclable according to their marking. By reusing, recycling or other forms of recycling old equipment, you make an important contribution to protecting our environment. Please contact the local administration the responsible disposal point.

Warranty

Our products are guaranteed for 2 years.

This guarantee only comes into effect if the lamp has remained unchanged and has been connected and used in accordance with the operating instructions.

Battery and LED are wear parts. We grant a one-year guarantee on the battery if it can be proven that it has been used within the specified temperature range.

The following information is given solely for the purpose of this manual and does not constitute a contractual commitment:

The quality of the batteries ensures that a service life of more than four years can be expected in accordance with the DIN/EN 60598-2-22 standard if the specified temperatures are maintained.

The green LED "3" lights up permanently when the battery is full.

Technical data

| | |
|--------------------------------|-----------------------------------|
| Illuminant | LED 3W |
| Colour temperature | 5300K |
| Performance level 1 / duration | approx 1W / 120lm / 10h |
| Performance level 2 / duration | approx 0,75W / 90lm / 14h |
| Performance level 3 / duration | approx 0,6W / 70lm / 18h |
| Connected load AC | max. 9,1VA |
| Connected load standby AC | max. 1,6VA |
| Rechargeable battery | OGIV 6V / 4,5Ah |
| Deep discharge protection | 4,8V |
| Degree of protection | IP43 |
| Protection class | III |
| Temperature range | +5°C bis 40°C |
| Dimensions (H x W x D) | 290 x 125 x 150 mm |
| Weight | 1580 g (without charging station) |

Installation and operating instructions of portable LED spotlight

Dimensioned drawing

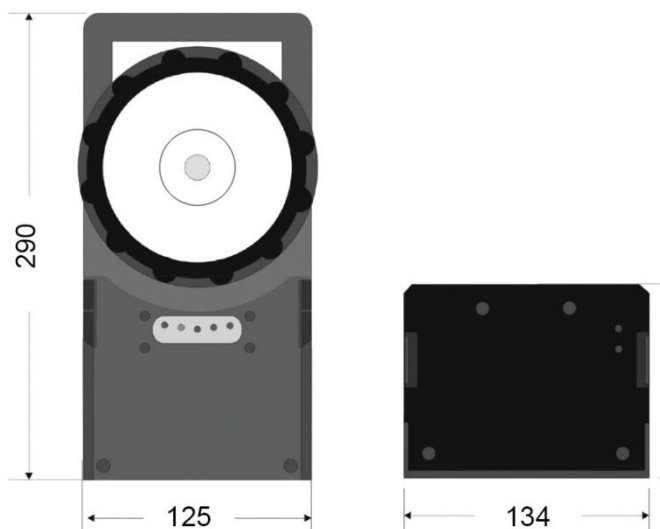

Function of the rotary switch

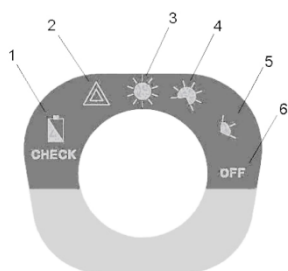

1. Battery status display
2. Warning light function
3. Power level 1 (100%)
4. Power level 2 (70%)
5. Power level 3 (30%)
6. Off

Battery charge level indicator

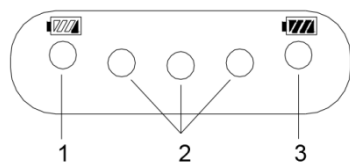

1. Battery is empty when LED "1" flashes red.
2. All LEDs "2" (red, yellow, green) are on when charging is completed.
3. The green LED "3" lights permanently when the battery is full.



Used batteries/rechargeable batteries and electronic devices must not be disposed of with household waste. As a buyer, you are obliged to dispose of batteries/accumulators and electronic devices at local collection points or in local shops.