



SMARTLUX 300 TWIN 5lx WM

Multi-purpose luminaire in compliance with EN 60598-1/2-22 and EN 1838.

Combined exit sign and 5lx safety luminaire. The safety luminaire will be delivered with two different optics, which can be changed easily due to click system. The robust polycarbonate luminaire has no screws for fast mounting. One special pictogram or one pictogram set - arrow left/right/down/up/blind (visibility distance 30 m) is included. Please choose when you order the luminaire. The exit sign part is equipped with a 1,5W LED-bar, the safety luminaire with a 3W power LED. Even though the luminaire combines two different types of luminaires, it is counted as one single luminaire within an electric circuit. The spot optic for illumination from above is already preassembled, the 20 degree optic for illumination according to EN 1838 is also enclosed.



Technical specifications

Luminaire type	Luminaires for central battery systems	Self contained luminaires
Illuminant	1.5 W LED-bar	1.5 W LED-bar
Illuminant safety modul	3W LED	3W LED
Visibility distance	30 m	
Connecting terminals	2 x 2.5 mm ² for double assignment	
Colour	white	
Material	Polycarbonate (light cover clear)	
Mounting type	Wall mounting	
Dimensions (W x H x D)	WM 313 x 176 x 54 mm	
Protection class	IP43	
Safety class	II	
IK Safety class	IK03	
Light current (mains)	190 lm	190 lm
Luminous flux Emergency (DC) / mains		
Rated operating time 1h	-	40% / 100%
Rated operating time 3h	-	40% / 100%
Rated operating time 8h	-	20% / 100%
Light (Net) current safety module	190 lm	-
Light current (Emergency) safety module		
Rated operating time 1h	-	190 lm
Rated operating time 3h	-	190 lm
Rated operating time 8h	-	80 lm
Luminous flux Emergency (DC) / mains safety module		
Rated operating time 1h	-	100% / 0%
Rated operating time 3h	-	100% / 0%
Rated operating time 8h	-	42% / 0%
Power consumption	11 VA	10 VA
Battery current input	27 mA	-
Battery duration	-	1h / 3h / 8h
Battery operation		
Voltage supply	230V 50/60Hz; 220V DC +25/-20%	230V 50/60Hz
NiMH-battery		
Rated operating time 1h	-	4,8V 2,0Ah
Rated operating time 3h	-	4,8V 2,0Ah
Rated operating time 8h	-	4,8V 2,0Ah
Temperature range	-10°C to +40°C	-
Non-maintained mode	-	0°C to +35°C
Maintained mode	-	-5°C to +30°C
Circuit options		
Pictogram	maintained mode DS	DS / BS switchable

Wall mounting

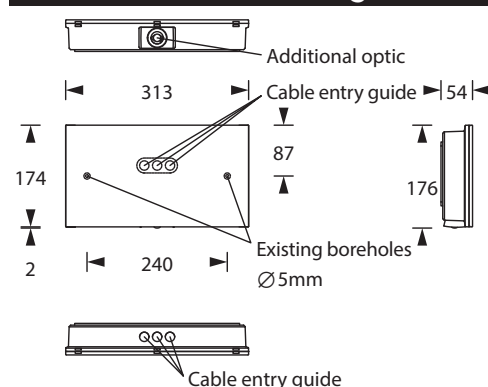

Safety modul	maintained mode DS (no monitoring), DS / BS switchable (with monitoring module)	non-maintained mode BS
optional		
Multi-switch and monitoring module	ELC MSÜ3 SET009 SET010	-
Self monitoring	-	SELF CHECK
Central monitoring	-	SAFELOG Line
Wireless monitoring	-	SAFELOG Wireless

Pictograms to choose from - please specify when ordering

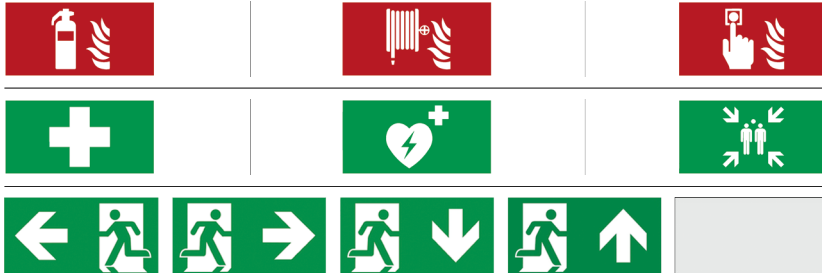

Optional pictograms (-sets)



Accessories

Wire guard

Pictograms

Lighting datas and graphics of luminaire distances (E = 5.00 lx)

Spot-optic

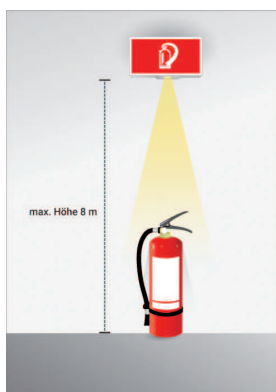

Wall mounting

The spot optic is for illumination from above e.g. for extinguisher which are mounted on a pillar like it is usual in warehouses or assembly halls. The space between luminaire to the ground can be max. 8 m.

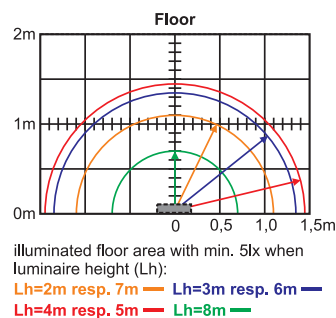
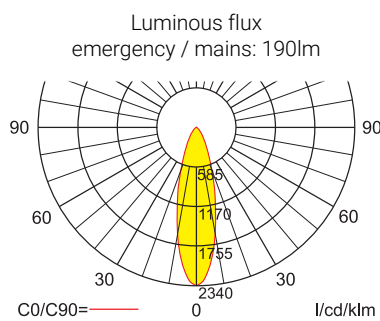

Luminous flux emergency / mains: 80lm

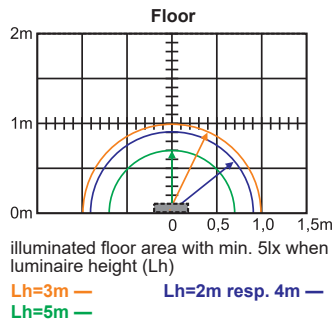
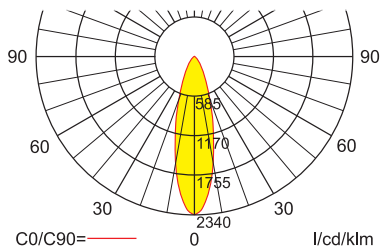

20 degree inclined optic

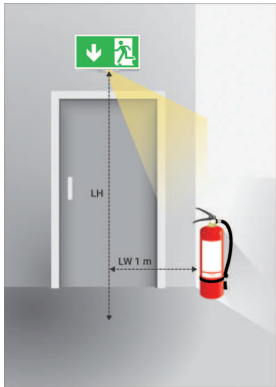

Wall mounting

The 20 degree inclined optic was constructed to meet the needs of the special demands according to EN 1838 in regards to illumination of firefighting equipment and safety devices like fire extinguishers, fire alarm and first aid devices with 5lx. The space between the luminaire and the object which has to be illuminated is max. 1 m.

Luminous flux emergency / mains: 190lm

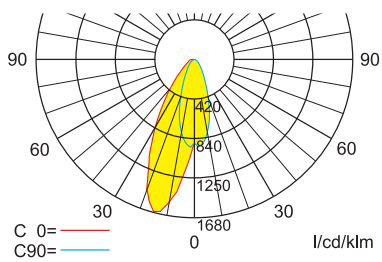

distance between luminaire and wall (LW)
LW = 1.0m

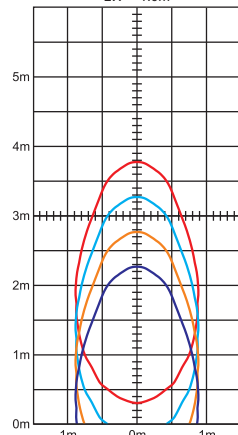

minimum illuminated area with 5lx at luminaire height (Lh)
Lh=4,0m — **Lh=3,5m** — **Lh=3,0m** — **Lh=2,5m** —

Luminous flux emergency / mains: 80lm

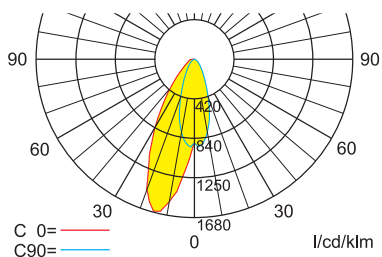

distance between luminaire and wall (LW)
LW = 1.0m

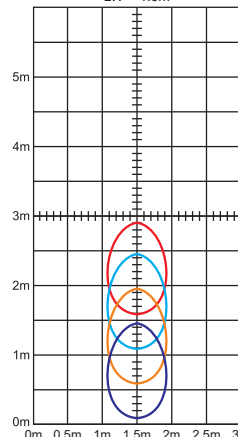

minimum illuminated area with 5lx at luminaire height (Lh)
Lh=4,0m — **Lh=3,5m** — **Lh=3,0m** — **Lh=2,5m** —