

# SMARTLUX 200 TWIN 5lx WM

## Multi-purpose luminaire in compliance with EN 60598-1/2-22 and EN 1838.

Combined escape sign and 5lx safety luminaire. The emergency luminaire is supplied with two different optics, which can be easily exchanged depending on the application thanks to the click system. The robust polycarbonate luminaire is screwless for quick installation. A single special pictogram with symbol according to ISO 7010 or optionally a pictogram set - arrow left/right/down/up/blind (visibility distance 23 m) is included with the luminaire free of charge. Please select this from the listing and specify it when ordering. The escape sign luminaire is equipped with a 1 Watt LED-bar, the emergency luminaire has a 1 x 3 W power LED. Despite the combination of two types of luminaires, this luminaire is only a single luminaire. Therefore, it is also counted as only one luminaire in the circuit. The spot optic for illumination from above is pre-mounted, the 20 degree tilted optic for illumination according to EN 1838 is enclosed.



## Technical specifications

Luminaire type	Luminaires for central battery systems	Self contained luminaires
Illuminant	1 W LED-bar	1 W LED-bar
Illuminant safety modul	3W LED	3W LED
Visibility distance	23 m	
Connecting terminals	2 x 2.5 mm <sup>2</sup> for double assignment	
Colour	white	
Material	Polycarbonate (light cover clear)	
Mounting type	Wall mounting	
Dimensions (W x H x D)	WM 243 x 141 x 54 mm	
Protection class	IP43	
Safety class	II	
IK Safety class	IK03	
Light current (mains)	130 lm	130 lm
Luminous flux Emergency (DC) / mains		
Rated operating time 1h	-	50% / 100%
Rated operating time 3h	-	50% / 100%
Rated operating time 8h	-	25% / 100%
Light (Net) current safety module	190 lm	-
Light current (Emergency) safety module		
Rated operating time 1h	-	190 lm
Rated operating time 3h	-	190 lm
Rated operating time 8h	-	80 lm
Luminous flux Emergency (DC) / mains safety module		
Rated operating time 1h	-	100% / 0%
Rated operating time 3h	-	100% / 0%
Rated operating time 8h	-	42% / 0%
Power consumption	10.5 VA	9.5 VA
Battery current input	26 mA	-
Battery duration Battery operation	-	1h / 3h / 8h
Voltage supply	230V 50/60Hz; 220V DC +25/-20%	230V 50/60Hz
NiMH-battery		
Rated operating time 1h	-	4,8V 2,0Ah
Rated operating time 3h	-	4,8V 2,0Ah
Rated operating time 8h	-	4,8V 2,0Ah
Temperature range	-10°C to +40°C	-
Non-maintained mode	-	0°C to +35°C
Maintained mode	-	-5°C to +30°C

## Wall mounting

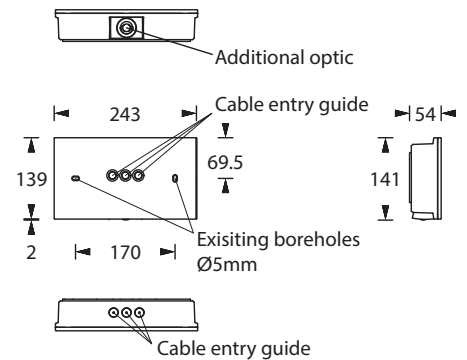

Circuit options		
Pictogram	maintained mode DS	DS / BS switchable
Safety modul	maintained mode DS (no monitoring), DS / BS switchable (with monitoring module)	non-maintained mode BS
optional		
Multi-switch and monitoring module	ELC MSÜ3 SET009 SET010	-
Self monitoring	-	SELF CHECK
Central monitoring	-	SAFELOG Line
Wireless monitoring	-	SAFELOG Wireless

### Pictograms to choose from - please specify when ordering

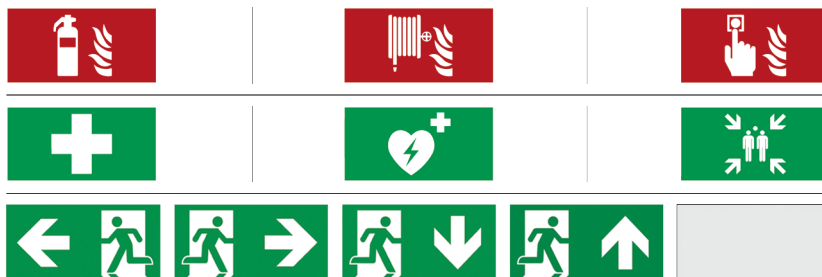

### Optional pictograms (-sets)



### Accessories

- Wire guard
- Pictograms

### Lighting datas and graphics of luminaire distances (E = 5.00 lx)

#### Spot-optic

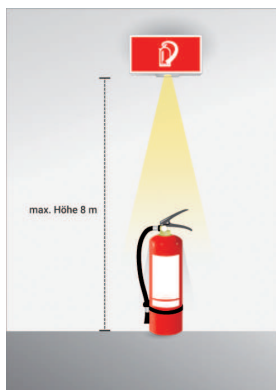

Wall mounting

The spot optic is for illumination from above e.g. for extinguisher which are mounted on a pillar like it is usual in warehouses or assembly halls. The space between luminaire to the ground can be max. 8 m.

Luminous flux  
emergency / mains: 190lm

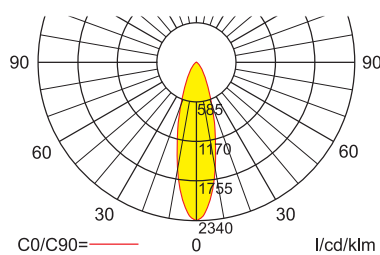

#### Floor

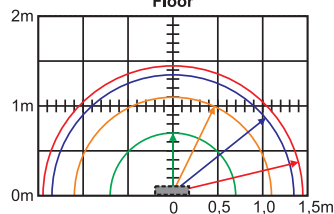

illuminated floor area with min. 5lx when luminaire height (Lh):  
 Lh=2m resp. 7m — Lh=3m resp. 6m —  
 Lh=4m resp. 5m — Lh=8m —

Luminous flux emergency / mains: 80lm

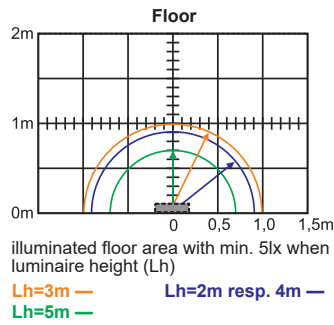
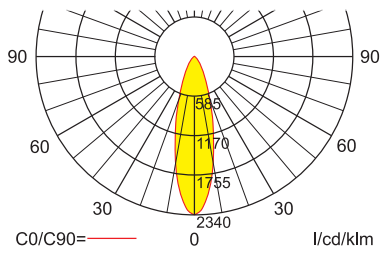

### 20 degree inclined optic

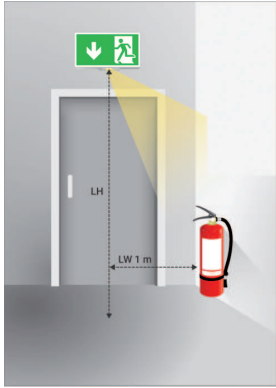

Wall mounting

The 20 degree inclined optic was constructed to meet the needs of the special demands according to EN 1838 in regards to illumination of firefighting equipment and safety devices like fire extinguishers, fire alarm and first aid devices with 5lx. The space between the luminaire and the object which has to be illuminated is max. 1 m.

Luminous flux emergency / mains: 190lm

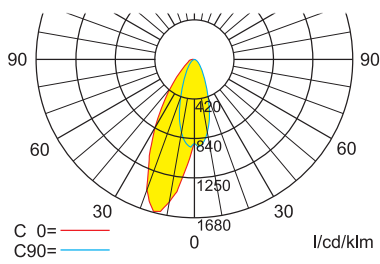

distance between luminaire and wall (LW)

LW = 1.0m

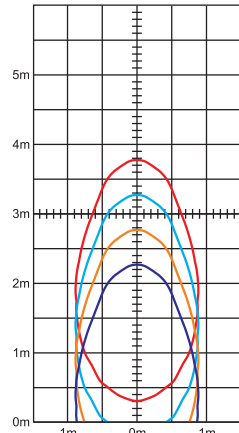

Luminous flux emergency / mains: 80lm

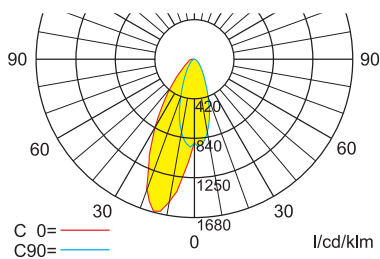

distance between luminaire and wall (LW)

LW = 1.0m

